



YANMAR

Wheel Loaders

V1-1A/V2-3B

Standard bucket capacity (0.16 / 0.3m³)







V1-1A V2-3B

Our most compact articulated wheel loaders are designed to deliver power and versatility



BUILDING WITH YOU

Features of V1-1A/V2-3B

V1-1A

Operating Seat

Adjustable operating seat.

Page 11

Compact Size

The 1245mm width allows it to fit through narrow passages.

Page 8

Forward / Reverse Pedal (no-clutch)

Easy to switch between forward and reverse travel directions.

Page 10

Articulated Steering

Offers great maneuverability in tight spaces.

Page 9

Travel Speed Modes

Choose from low and high speed modes to tackle jobs.

Page 10

Wide-Open Engine Bonnet

Easy inspection and maintenance.

Page 11

Lockable Operating Lever

Prevents from accidental operations.

Page 10

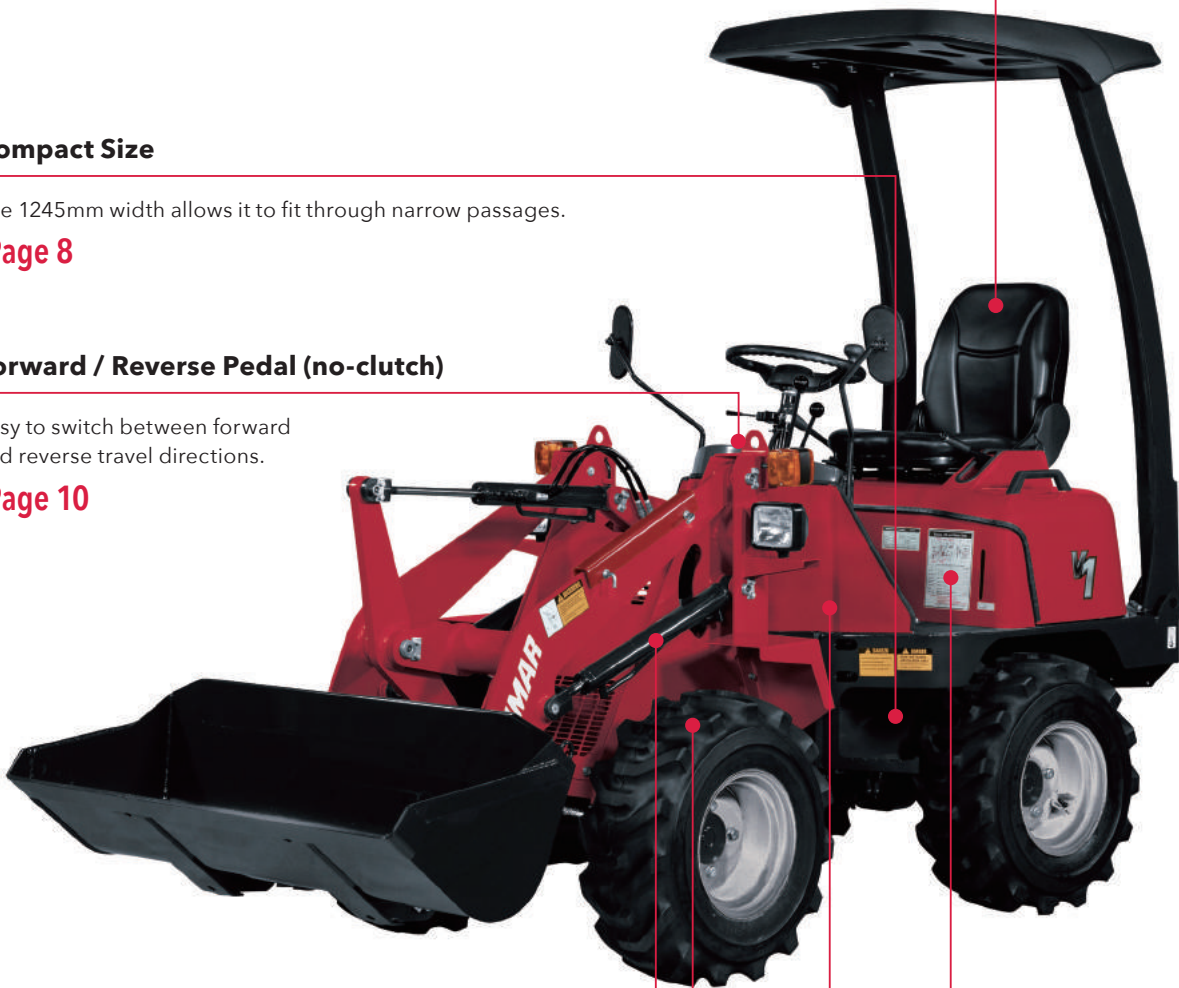

V2-3B



Wide-Open Engine Bonnet

Easy inspection and maintenance.

Page 17

Forward / Reverse Lever (no-clutch)

Easy to switch between forward and reverse travel directions.

Page 15

Reclining and Sliding Seat

Adjustable to fit the operator's body and posture.

Page 15

Traction and Breakout Force

Equipped with a high performance engine for powerful traction and breakout force.

Page 13

Iron Cast Counterweight

Provides protection and great balance for lifting applications.

Page 16

Reverse Light and Backup Alarm

Both features are automatically activated when reversing. Ensures maximum safety.

Page 16

Automatic Leveler

Place the bucket evenly on the ground with one push of a lever.

Page 13

Articulated Steering

Offers great maneuverability in tight spaces.

Page 13

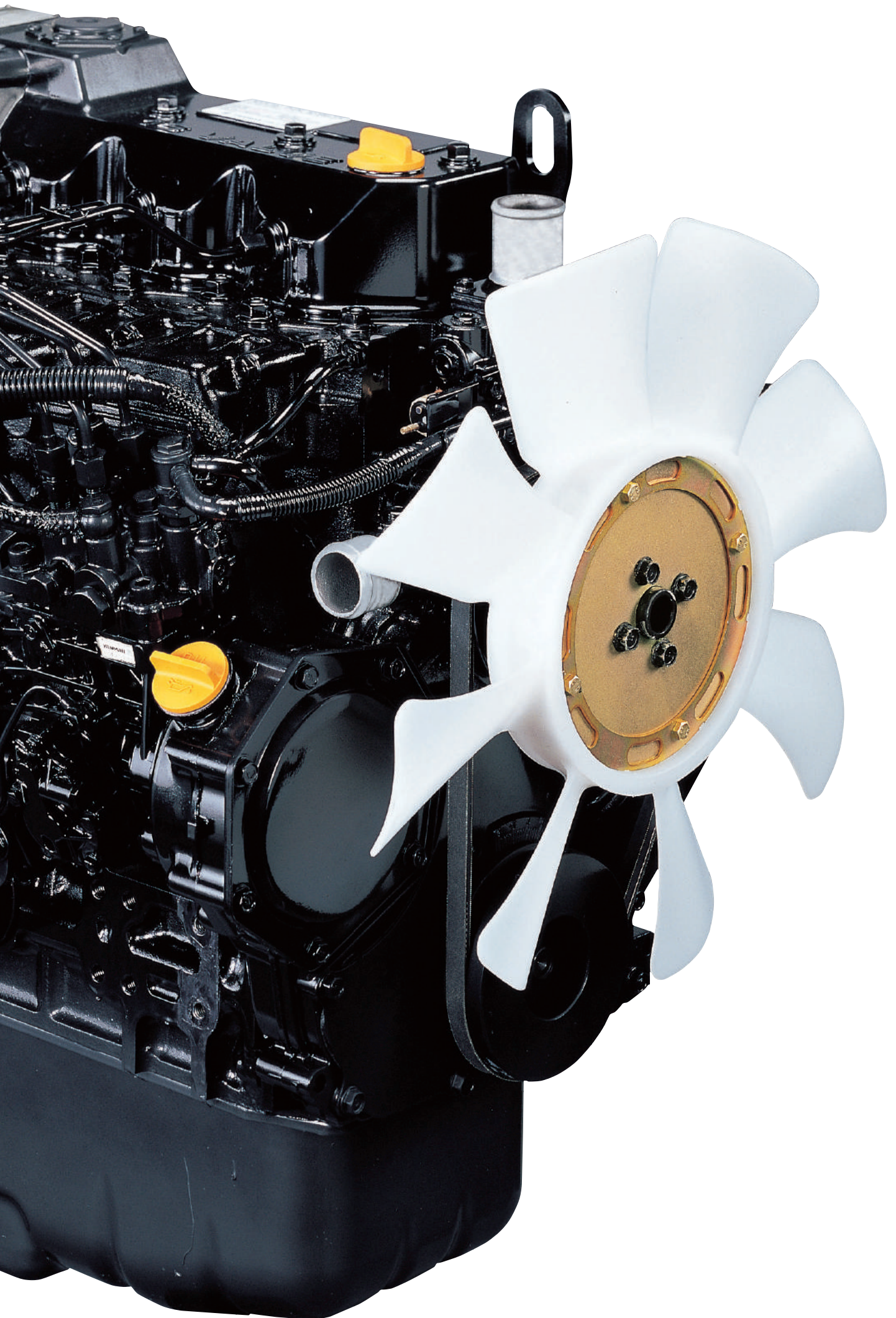

Reliable YANMAR engine designed to deliver powerful output and fuel efficiency

YANMAR Engine

Equipped with legendary YANMAR TNV engines.

They guarantee high quality, power and efficiency thanks to advanced technologies.

V1-1A

Model **3TNV70-MKAH** Output (Gross) **12.5kW**

V2-3B

Model **3TNV82A-QKAH** Output (Gross) **17.3kW**



High Performance Engine

High performance engines provide a powerful boost for tough works.



Clean and Low-Noise

Ultra-low noise design, friendly to people and the environment.

V1-1A

V1-1A | V2-3B



Machine width **1245mm**

Operating weight **1110kg**

Minimum turning radius
(at outermost)

2560mm

V1-1A is designed for tight job sites. The narrow machine width allows it to fit through narrow passages.

Compact and multi-purpose



Center Joint Oscillation

±8° center joint oscillation provides excellent stability and performance on uneven ground. It helps to reduce operator fatigue.



Dumping Clearance and Reach

V1-1A gets more loading and unloading job done thanks to its great dumping height and operating load.

① Dumping clearance **1715mm** ② Dumping reach **535mm**

*The length is measured when dumping.

③ Operating Load **270kg**



Articulated Steering

An articulated steering achieves tight turning radius with its 40° steering angle. It also enables the rear tires to follow the path of front tires when turning, for a great maneuverability in narrow spaces.

Comfortable operator space

V1-1A
V2-3B



1

Travel Speed Modes

Choose the suitable speed for your job application from low and high speed modes.



2

Lockable Operating Lever

Operating lever is easy to use. It can be locked to prevent from accidental operations.



3

Forward / Reverse Pedal (no-clutch)

The forward and reverse gear can be easily switched by pedal. It comes with safety lock to avoid accidents.

Easy maintenance and enhanced safety



1

Wide-Open Engine Bonnet

A wide opening enables easy access to daily maintenance.



2

Operating Seat

Adjustable seat to fit operator's body and posture.

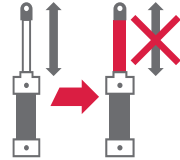

Cylinder Safety Lock

The boom can be locked when raised, allowing for safe inspections and maintenance.

V1-1A
V2-3B



V2-3B

V1-1A
V2-3B



Machine width **1400mm**
Operating weight **1940kg**

Dumping clearance **1865mm**
Dumping reach **685mm**

*The length is measured when dumping

Operating Load
500kg

Compact and powerful



V1-1A
V2-3B

Traction and Breakout Force

V2-3B is equipped with a powerful 17.3kW engine. It delivers high output for traction and breakout force.



Articulated Steering

An articulated steering achieves tight turning radius with its 42° steering angle. It also enables the rear tires to follow the path of front tires when turning, for a great maneuverability in narrow spaces.

Minimum turning radius
(at outermost)

3000mm

AUTOMATIC



Automatic Leveler

Place the bucket evenly on the ground with one push of a lever. Boost productivity by transitioning seamlessly from dumping to scooping.

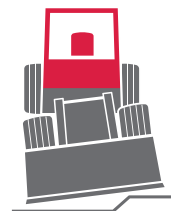

Center Joint Oscillation

±8° center joint oscillation provides excellent stability and performance on uneven ground. It helps to reduce operator fatigue.

Comfortable operator space

V1-1A
V2-3B





1

Automatic Speed Mode

Step on the pedal and the wheel loader accelerates smoothly and changes gears automatically.



2

Low Speed Mode

The speed can be limited to 8km/h by switching on the low speed mode. This feature is convenient for jobs in restricted areas.



3

Power Steering

Reduces the effort of operator to turn the steering wheel. It helps to decrease operator fatigue.



4

Lockable Operating Lever

Operating lever is easy to use. It can be locked to prevent from accidental operations.



5

Forward / Reverse Lever (no-clutch)

The forward and reverse gear can be easily switched by lever. It comes with safety lock to avoid accidents.



6

Inching pedal

The inching pedal is used to distribute engine output between driving power and working hydraulics. It enables you to fine tune the hydraulic performance and increase productivity.



7

Parking Brake Pedal

The parking brake ensures secure parking. Step on the pedal to activate the parking mode. Lightly press the pedal and pull the release lever to deactivate the parking mode.



8

Reclining and Sliding Seat

Adjustable seat to fit operator's body and posture.



9

Walk-through

A walk-through enables operator to get on and off the machine from both sides. It is highly efficient when operating right next to obstacles.

Enhanced safety

V1-1A
V2-3B



1 Iron Cast Counterweight

The rear of the wheel loader is firmly guarded by a large iron cast counterweight. It also acts as a great balance for lifting job applications.



2 Reverse Light and Backup Alarm

Both features are automatically activated when reversing. Ensures maximum safety at the job sites.



3 Headlights and Turn Signal Lights

Headlights and sidelights integrated into turning signal lights ensure safe travel at night.

Easy maintenance



4

Wide-Open Engine Bonnet

A wide opening enables easy access to daily maintenance.

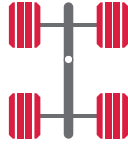

5

Drive Unit

Floor cover is easily removed to access drive unit for easy inspection and maintenance.

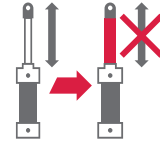

Cylinder Safety Lock

The boom can be locked when raised, allowing for safe inspections and maintenance.

V1-1A
V2-3B

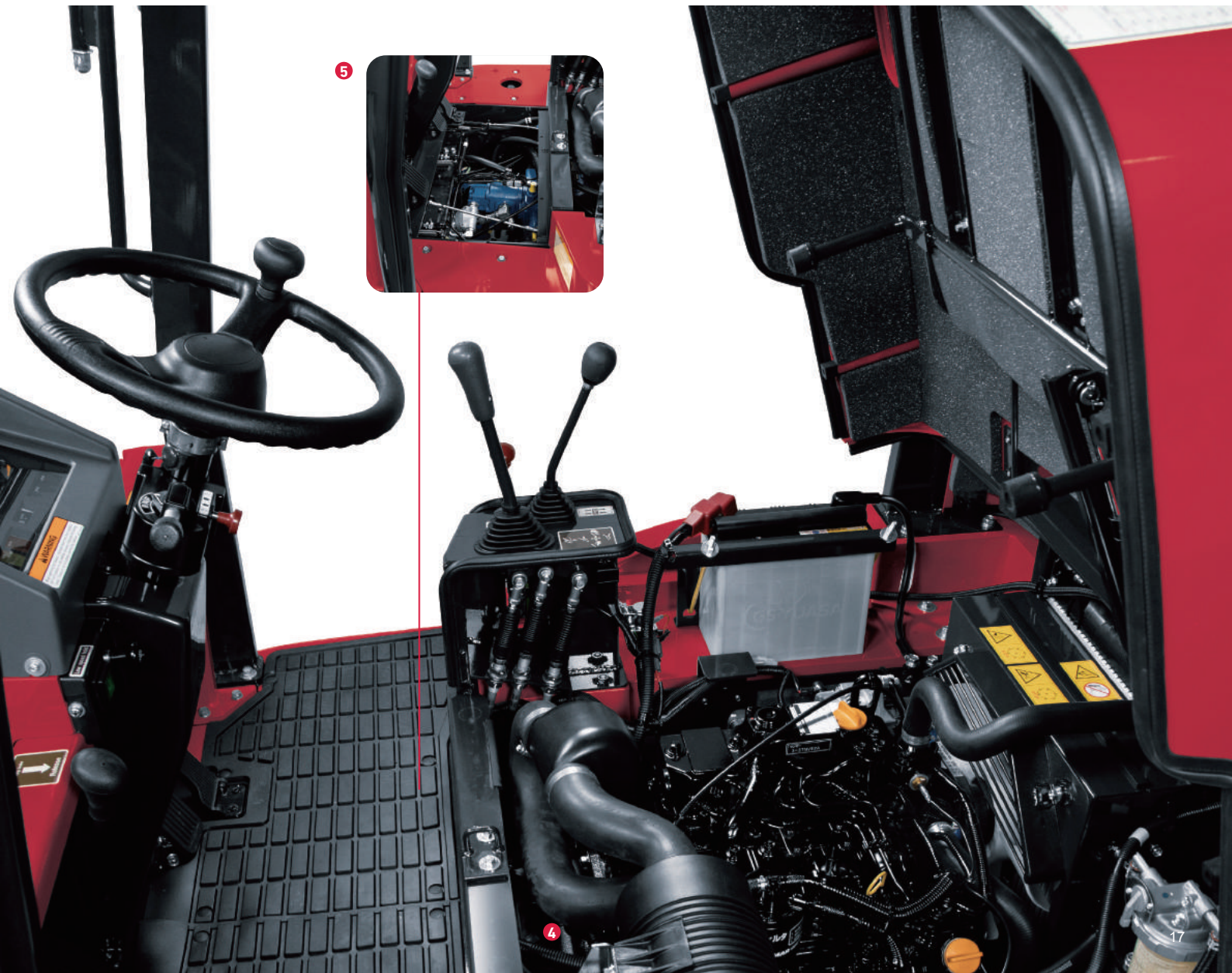

5

4

Selection of optional equipment

Configuration for Agriculture Application (V2-3B only)

This configuration comes with zinc plated bucket and wheel rims. Zinc plate prevents them from rusting.



Zinc Plated Bucket



Zinc Plated Wheel Rims



Mechanical Quick Coupler (Optional)

Quick coupler makes it easier and quicker than ever to change buckets and other attachments. It saves time so operator can focus job in hand.



P.T.O. Hydraulic Line (V2-3B only)

Powerful hydraulic P.T.O. line is available as an option. Enables easy, fast and intuitive control of various attachments.

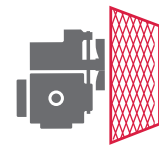

Radiator Dust Guard (V2-3B only)

The dust guard stops from external substances going into the radiator. It reduces cleaning time of radiator.

● Dimensions

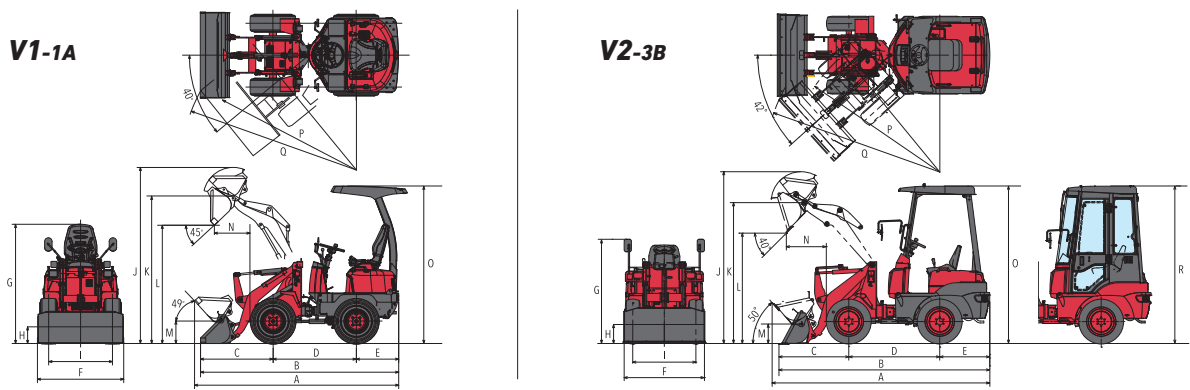

Unit:mm (in.)

	A	B	C	D	E	F	G	H	I	J	K	L	M	N	O	P	Q	R
V1-1A	2920 (115.0)	2870 (113.0)	1060 (41.7)	1200 (47.2)	610 (24.0)	1245 (49.0)	1590 (62.6)	210 (8.3)	920 (36.2)	2540 (100.0)	2115 (83.3)	1715 (67.5)	255 (10.0)	535 (21.1)	2275 (89.6)	2140 (84.3)	2560 (100.8)	-
V2-3B	3680 (144.9)	3620 (142.5)	1215 (47.8)	1550 (61.0)	855 (33.7)	1400 (55.1)	1790 (70.5)	250 (9.8)	1080 (42.5)	2990 (117.7)	2380 (93.7)	1865 (73.4)	300 (11.8)	685 (27.0)	2520 (99.2)	2600 (102.4)	3000 (118.1)	2520 (99.2)

● Specifications

MODEL			V1-1A	V2-3B	
TYPE			Canopy	Canopy	
WEIGHT	Operating weight	kg (lbs.)	1110 (2447)	1940 (4278)	
BUCKET	Capacity, standard	cu.m (cu.ft)	0.16 (5.7)	0.3 (10.6)	
ENGINE	Type		Water-cooled 3-cylinder diesel engine		
	Model		3TNV70-MKAH	3TNV82A-QKAH	
	Rated output	Gross	kW (HP) / rpm	12.5 (16.8) / 2600	17.3 (23.2) / 2300
		Net	kW (HP) / rpm	12.4 (16.6) / 2600	16.9 (22.7) / 2300
	Displacement		cu.cm (cu.in.)	854 (52.1)	1330 (81.2)
PERFORMANCE	Operating load		kN (lbs.)	2.6 (595)	4.9 (1102.3)
	Lifting capacity	at Low end	kN (lbs.)	7.7 (1731.0)	14.7 (3304.6)
		at Max reach	kN (lbs.)	4.2 (994.2)	12.7 (2855.0)
	Tipping load	Straight	kN (lbs.)	6.5 (1461.2)	15.0 (3372.1)
		Full turn	kN (lbs.)	5.3 (1191.4)	12.7 (2855.0)
	Breakout force		kN (lbs.)	8.0 (1798.4)	15.2 (3417.1)
	Dumping clearance		mm (in.)	1715 (67.5)	1865 (73.4)
	Min. ground clearance		mm (in.)	210 (8.3)	250 (9.8)
Min. turning radius, at outermost		mm (in.)	2560 (100.8)	3000 (118.1)	
Max. travel speed, high / low		km/h (mph)	10 (6.2) / 6.1 (3.8)	15.0 (9.3) / 8.0 (5.0)	
ELECTRONIC	Battery voltage, 5 hrs rate capacity	V - Ah	12 - 36	12 - 36	
	Generator capacity	V - A	12 - 40	12 - 55	
HYDRAULIC SYSTEM	Pump displacement	cu.cm / rev (cu.in. / rev)	0 to 14.4 (0 to 0.88)	0 to 28 (0 to 1.71)	
	Relief valve set pressure, high / low	MPa (PSI)	20.6 (2987.8) / 0.2 (29.0)	37.5 (5438) / 2.5 (363)	
	Max. P.T.O. output	L/min (gpm)	15.6 (4.12)	32.4 (8.55)	
STEERING SYSTEM	Type		Articulated steering	Articulated steering	
	Articulation angle	degrees	40	42	
DRIVE SYSTEM	Type		4-wheel drive	4-wheel drive	
	Oscillation angle	degrees	± 8	± 8	
	Tires		10 / 70 - 12 - 4PR	10 - 16.5 - 6PR	
TRANSMISSION	Type		Automatic hydrostatic	Automatic hydrostatic	
BRAKES	Type		Fully enclosed, wet, multiple disc	Fully enclosed, wet, multiple disc	
	Operation method		Mechanical	Mechanical	
TRANSPORT DIMENSIONS	L × W × H	mm (in.)	2870 × 1245 × 2275 (113 × 49 × 90)	3620 × 1400 × 2520 (142.5 × 55.1 × 99.2)	
TANK CAPACITY	Fuel tank	L (gal)	15.7 (4.15)	25 (6.60)	
	Engine oil	L (gal)	3.3 (0.87)	3.6 (0.95)	
	Hydraulic oil, tank / other parts	L (gal)	12.5 (3.30) / 4.5 (1.19)	23 (6.07) / 5 (1.32)	
	Coolant, radiator	L (gal)	3 (0.79)	4.1 (1.08)	
	Axle, front / rear	L (gal)	2.3 (0.61) / 2.3 (0.61)	3.5 (0.92) / 4.0 (1.05)	

All data are subject to change without notice. Note that the standard equipment may vary. Consult your YANMAR dealer for confirmation.



YANMAR COMPACT EQUIPMENT



yanmar.com